

# 157 Bedford Street, Burlington, MA



## RETAIL SPACE - FOR LEASE

**TOTAL AVAILABLE: 3,016 +/-SF**

**UNIT A1:** 1,576 +/-sf

**UNIT A2:** 1,440 +/- sf

- Retail space
- 3 Restrooms common to units A1 and A2
- Exterior retail sign positioning
- On-site, shared parking lot. 38 +/- spaces
- Zoned: B-G (Business General)
- Located on Route 62. 0.2 miles to the Middlesex Turnpike, 0.5 miles to Route 3, 1.1 miles to the shops at 3<sup>rd</sup> Avenue, and 1.8 miles to the Burlington Mall & Route 95/128
- \$32.00 per sf nnn  
(nets estimated at \$16.24 per sf)

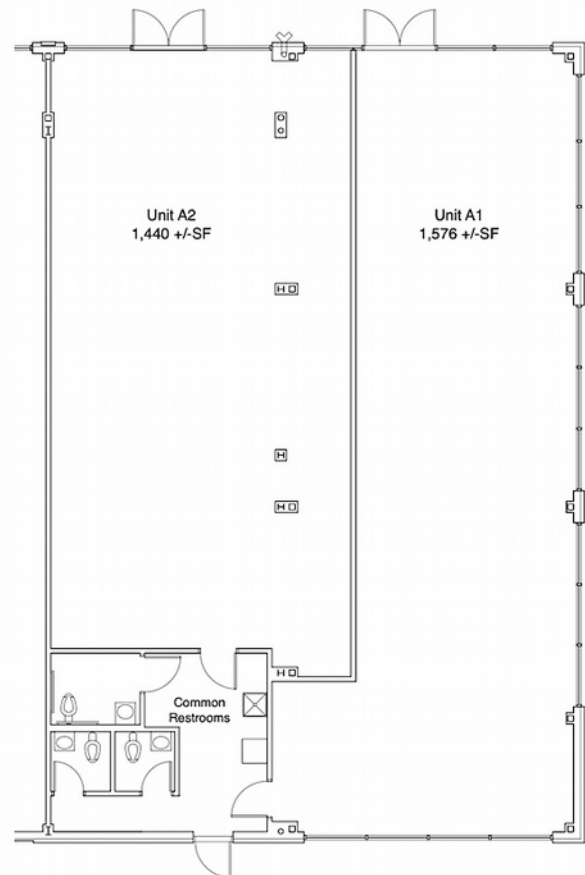

Edward Carbone, CCIM

781.935.5444 (o)

978.930.1579 (c)

Edward@CarboneRE.com

CarboneRE.com

## CARBONE Commercial Real Estate, Inc.

All information furnished is from sources deemed reliable, but no warranty or representation is made as to the accuracy thereof, and the same is presented subject to errors, omissions, change of price, rental or other conditions, prior sale or lease, or withdrawal without notice. Copyright © 2026 Carbone Commercial Real Estate, Inc., agent of the Owner/Lessor.

# 157 Bedford Street, Burlington, MA



781.935.5444 (o)  
CarboneRE.com

CARBONE Commercial Real Estate, Inc.