

23 Cambridge Street, Burlington, MA



Commercial Retail Space - For Lease

- **Unit A:** 2,718 +/-sf
- Single-story Retail showroom
- Large front display windows
- 2 Common restrooms
- Air conditioned
- Front ramped entry
- 20 Shared parking spaces
- High visibility location along Route 3 across from one of Burlington's most heavily visited retail plazas with multiple chain anchor stores.
- Zoned: B-G



Edward Carbone, CCIM

781.935.5444 (o)

978.930.1579 (c)

Edward@CarboneRE.com

CarboneRE.com

CARBONE Commercial Real Estate, Inc.

All information furnished is from sources deemed reliable, but no warranty or representation is made as to the accuracy thereof, and the same is presented subject to errors, omissions, change of price, rental or other conditions, prior sale or lease, or withdrawal without notice. Copyright © 2025 Carbone Commercial Real Estate, Inc., agent of the Owner/Lessor.

PROPOSED SUB-DIVISION PLAN

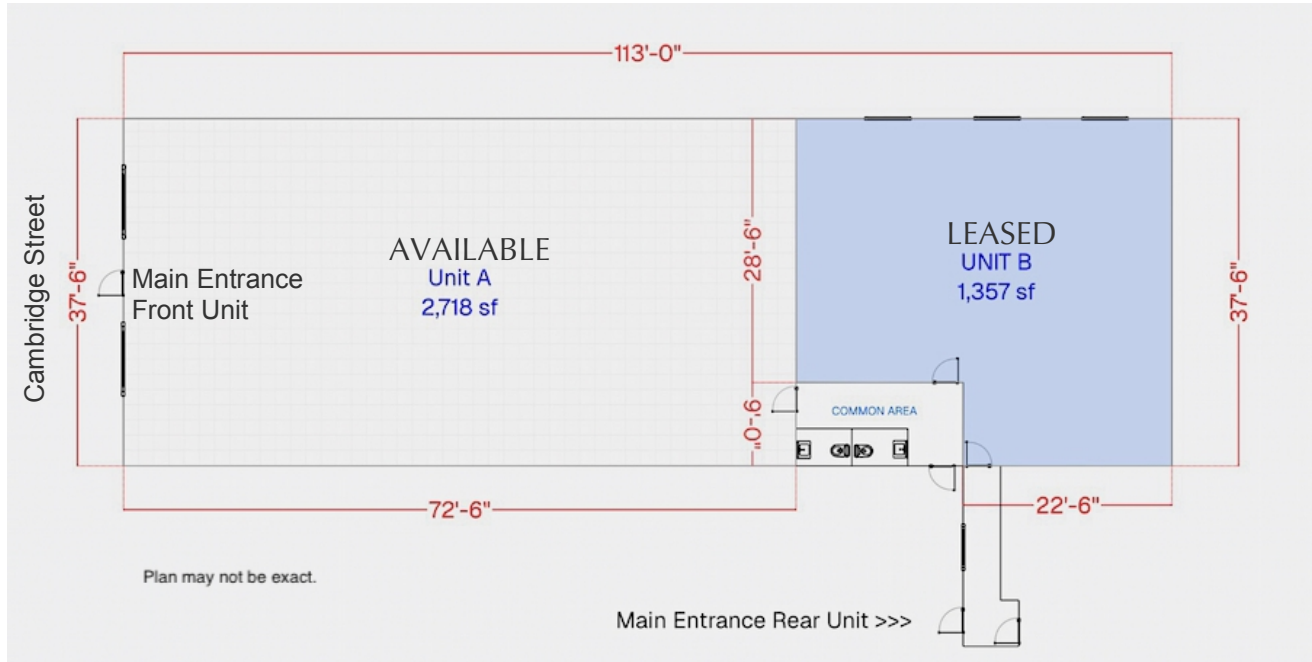

23 Cambridge Street, Burlington, MA



781.935.5444
CarboneRE.com

CARBONE Commercial Real Estate, Inc.