

323 Andover Street, Wilmington, MA



323 Andover Street is a 26,000 sf multi-tenanted industrial office building consisting of office, storage, and light manufacturing space.

6,236 SF Industrial / Office Space For Lease

- **Building 2:** 6,236 +/-sf
 - Industrial/light manufacturing 2,650 +/-sf
 - Office 3,586 +/-sf
- Industrial ceiling 10'H +/-
- 3-Phase electric service
- Loading dock with overhead loading door
- 7 Offices plus large conference room
- 2 Restrooms
- Direct exterior entry into the unit from both the front and rear
- Common on-site daytime parking
- Zoned: General Industrial
- Located 1.1 miles to Route 93; 6.8 miles to Route 495; 7.1 miles to Route 95/128; 20 miles to Logan International Airport; and 36 miles to Manchester Regional Airport
- Base Rent: \$6,500 per month
Real Estate Taxes: \$1,300+/- per month
Plus utilities

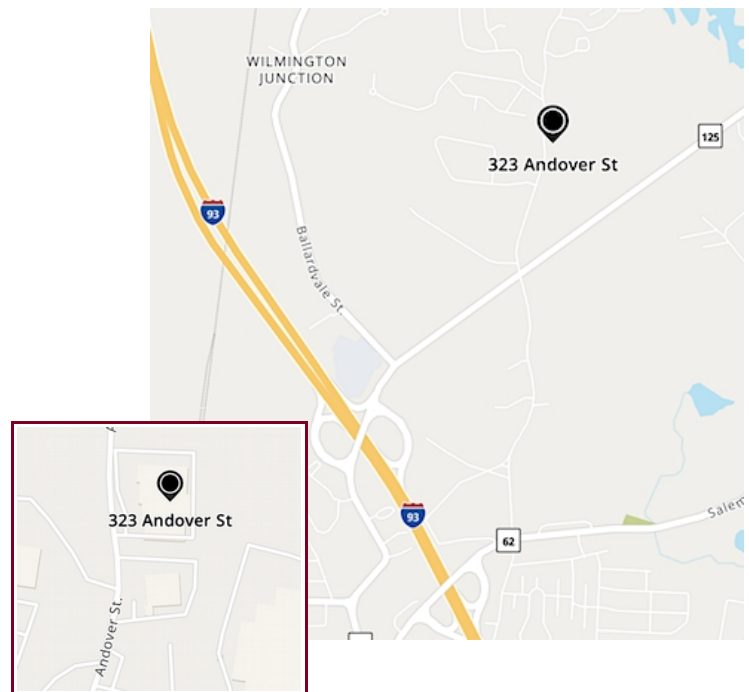

Edward Carbone, CCIM

781.935.5444 (o)

978.930.1579 (c)

Edward@CarboneRE.com

CarboneRE.com

CARBONE Commercial Real Estate, Inc.

All information furnished is from sources deemed reliable, but no warranty or representation is made as to the accuracy thereof, and the same is presented subject to errors, omissions, change of price, rental or other conditions, prior sale or lease, or withdrawal without notice. Copyright © 2025 Carbone Commercial Real Estate, Inc., agent of the Owner/Lessor.

323 Andover Street, Wilmington, MA

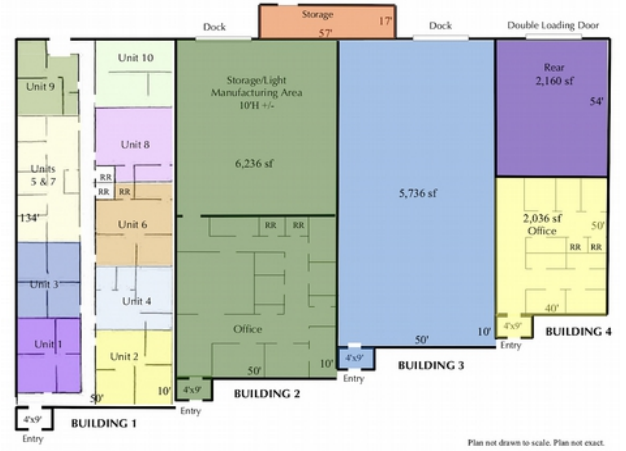
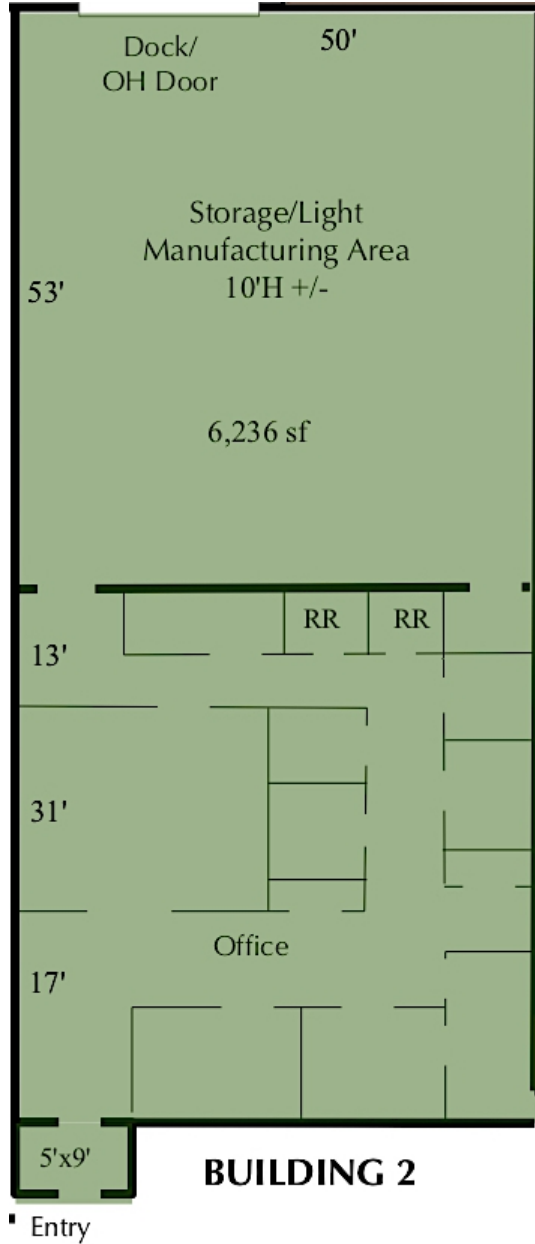

781.935.5444

CarboneRE.com

CARBONE Commercial Real Estate, Inc.

323 Andover Street, Wilmington, MA



781.935.5444
CarboneRE.com

CARBONE Commercial Real Estate, Inc.